



## NANTONG INTLEVEL TRADE CO.,LTD

Building 7, Zhichuang Park, No. 6 Xinsheng Road,  
Nantong, Jiangsu, China

Tel: +86-513-85587351 Fax: +86-513-85587659

Mail: sales@intlevel.cn

### ● Hammer Drive Anchors



### ● Wall Plugs



### ● Speed Anchors



### ● Butterfly Toggle Anchors



### ● PP Insulation Plugs



### ● Snap Toggle Anchors



### ● Concrete Screws



### ● Bolt Anchors



### ● Cavity Anchors



# About Intlevel



Intlevel is a trusted supplier of high-quality hardware, plastic components, and customized engineering solutions for global markets. With a strong focus on innovation, precision, and long-term partnerships, we proudly serve industries such as construction, electrical, and home improvement.

## Team & Culture

At Intlevel, we believe that investing in people is the foundation of long-term success. Our team is built on shared values of professionalism, collaboration, and a strong learning spirit. We regularly organize a wide range of internal and external training programs. These training not only enhance individual abilities, but also strengthen teamwork and innovation across the company. When our people grow, so does our potential.



20<sup>+</sup>

Export Experience

100<sup>+</sup>

Product Types

60<sup>+</sup>

Number of Employees



**Customer First**



**Value Orientation**



**Shared Responsibility**

## Inspection & Certification

At Intlevel, product quality is ensured through rigorous inspection at every stage.

We are equipped with a variety of testing devices to perform in-process checks and pre-shipment sampling, making sure each batch meets customer requirements and international standards.

“Reliable products start with reliable testing.”

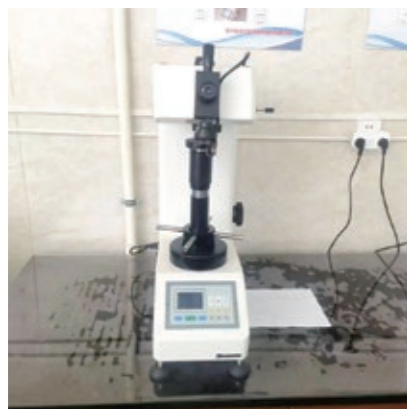

◀ **HV Vickers Hardness Tester**  
Hardness testing of various materials



**Rockwell Hardness Tester**  
Hardness testing of various materials ▶



▲ **Roughness Tester**  
Testing the roughness of materials



▲ **Spectrometer**  
Testing the chemical composition of materials



▲ **Grinding and Polishing Machine**  
Pre - grinding and polishing



▲ **Cutting Machine**  
Cutting various materials



▲ **Universal Testing Machine**  
Testing the tensile force of bolts and the load - retaining capacity of nuts

### ■ We proudly hold the following certifications:

- ISO 9001: Quality Management System
- CE Certification

# Packaging & Warehousing

At Intlevel, we understand that packaging is not just about appearance – it's about protection, precision, and trust. We offer a range of customized packaging solutions tailored to different product types and shipping requirements. From bulk cartons to branded boxes, every detail is designed to ensure safe handling, easy storage, and damage-free delivery. Our well-organized warehouse system supports efficient inventory management and fast dispatch, helping clients receive the right products, right on time.



Plastic Bag



Zip-lock Bag



Hang Tag



Blister Card



Plastic Drum



Plastic Box

# Packaging



Mailer Box



Shelf-Ready Packaging



Neutral Small Box



Neutral Carton

## ■ Efficient Warehousing



Intlevel utilizes a well-defined zoning system to organize inventory, ensuring that each batch of goods is stored neatly and systematically within fixed areas. Clear labeling combined with an advanced management system allows for rapid location and precise retrieval of every shipment, significantly improving storage efficiency and operational speed.

# CATALOGUE

## 🔍 Hammer Drive Anchors



Part NO:INT11455	16
Part NO:INT11456	17
Part NO:INT11457	18
Part NO:INT11459	18
Part NO:INT11458	19
Part NO:INT11462	19
Part NO:INT11460	20
Part NO:INT11464	20
Part NO:INT11461	21
Part NO:INT11465	21



## Wall Plugs

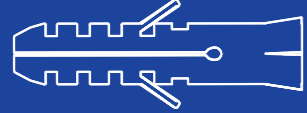

Part NO:INT11421	23
Part NO:INT11466	23
Part NO:INT11467	24
Part NO:INT11477	24
Part NO:INT11472	24
Part NO:INT11423	25
Part NO:INT11475	25
Part NO:INT11473	25
Part NO:INT11422	25
Part NO:INT11474	26
Part NO: INT11469	26
Part NO:INT11470	26
Part NO:INT11479	26
Part NO:INT11485	27



## Speed Anchors



Part NO:INT11442	29
Part NO:INT11485	29
Part NO:INT11486	29
Part NO:INT11441	29
Part NO:INT11443	29



## Butterfly Toggle Anchors



Part NO:INT11482	31
Part NO:INT11424	31
Part NO:INT11483	31



## PP Insulation Plugs



Part NO:INT11436	33
Part NO:INT11444	33
Part NO:INT11484	33



## Concrete Screws



Part NO:INT11509	35
Part NO:INT11510	35
Part NO:INT11511	35



## Bolt Anchors



Part NO:INT11512	37
Part NO:INT11513	37
Part NO:INT11514	37
Part NO:INT11431	38
Part NO:INT11427	38
Part NO:INT11428	39
Part NO:INT11429	39
Part NO:INT11430	39
Part NO:INT11435	40
Part NO:INT11437	40
Part NO:INT11433	41
Part NO:INT11409	41
Part NO:INT11519	42
Part NO:INT11409	42
Part NO:INT11434	43
Part NO:INT11410	43



## Snap Toggle Anchors



Part NO:INT11425	45
------------------	----



## Cavity Anchors



Part NO:INT11414	47
Part NO:INT11416	47
Part NO:INT11415	48
Part NO:INT11417	48
Part NO:INT11449	48
Part NO:INT11440	49
Part NO:INT11439	49
Part NO:INT11418-420, 515-518	50

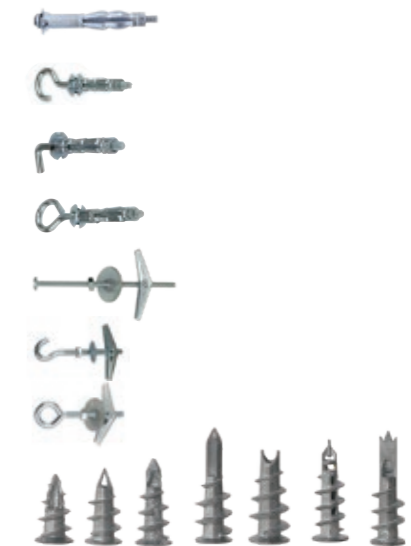



## Part NO:INT11455

Hammer Drive Anchor Countersunk Head, With Pozi Head Screw  
 Material:(Sleeve)PA/PE; (Screw)Steel/Stainless Steel



### Description:

Anchor Size(mm)	Drill Dia(mm)	Plug Length(mm)	Screw Size(mm)
5x25	5	25	3.5x28
5x30	5	30	3.5x33
5x35	5	35	3.5x38
5x40	5	40	3.5x43
5x45	5	45	3.5x48
5x50	5	50	3.5x53
6x30	6	30	3.8x33
6x35	6	35	3.8x38
6x40	6	40	3.8x43
6x45	6	45	3.8x48
6x50	6	50	3.8x53
6x55	6	55	3.8x58
6x60	6	60	3.8x63
6x70	6	70	3.8x73
6x80	6	80	3.8x83
6x100	6	100	3.8x103
8x40	8	40	4.8x43
8x45	8	45	4.8x48
8x60	8	60	4.8x63
8x80	8	80	4.8x83
8x100	8	100	4.8x103
8x120	8	120	4.8x123
8x135	8	135	4.8x138
8x140	8	140	4.8x143
8x160	8	160	4.8x163
10x80	10	80	5.8x83
10x100	10	100	5.8x103
10x120	10	120	5.8x123
10x135	10	135	5.8x138
10x140	10	140	5.8x143
10x160	10	160	5.8x163

## Hammer Drive Anchors

Hammer Drive Anchors are a versatile and efficient fastening solution designed for light-duty fixing into concrete, brick, and masonry. With a quick and easy installation process, they are ideal for applications where speed and reliability are essential.

Whether you're working on construction, renovation, or utility installation, our hammer drive anchors offer a strong hold and hassle-free experience. Available in a range of sizes and packaging options to suit your project needs.

## Part NO:INT11456

Hammer Drive Anchor Round Head, With Pozi Head Screw  
Material:(Sleeve)PA/PE; (Screw)Steel/Stainless Steel



### Description:

Anchor Size(mm)	Drill Dia(mm)	Plug Length(mm)	Screw Size(mm)
5x30	5	30	3.5x33
5x35	5	35	3.5x38
5x50	5	50	3.5x53
6x35	6	35	3.8x38
6x40	6	40	3.8x43
6x50	6	50	3.8x53
6x55	6	55	3.8x58
6x60	6	60	3.8x63
6x70	6	70	3.8x73
6x80	6	80	3.8x83
8x45	8	45	4.8x48
8x60	8	60	4.8x63
8x80	8	80	4.8x83
8x100	8	100	4.8x103
8x135	8	135	4.8x138
8x140	8	140	4.8x143

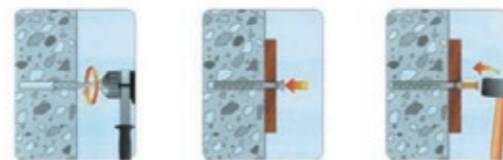

## Part NO:INT11457

Hammer Drive Anchor Mushroom Head, With Pozi Head Screw  
Material:(Sleeve)PA/PE; (Screw)Steel/Stainless Steel



### Description:

Anchor Size(mm)	Drill Dia(mm)	Plug Length(mm)	Screw Size(mm)
6x35	6	35	3.8x38
6x40	6	40	3.8x43
6x60	6	60	3.8x63
6x80	6	80	3.8x83
8x60	8	60	4.8x63
8x80	8	80	4.8x83
8x100	8	100	4.8x103
8x120	8	120	4.8x123
8x140	8	140	4.8x143

## Part NO:INT11459

Hammer Drive Anchor Mushroom Head, "S" Type, With Pozi Head Screw  
Material:(Sleeve)PA/PE; (Screw)Steel/Stainless Steel



### Description:

Anchor Size(mm)	Drill Dia(mm)	Plug Length(mm)	Screw Size(mm)
6x40	6	40	3.8x43
6x60	6	60	4.0x65
6x80	6	80	4.0x85

## Part NO:INT11458

Hammer Drive Anchor Countersunk Head, "S" Type, With Pozi Head Screw  
Material:(Sleeve)PA/PE; (Screw)Steel/Stainless Steel



### Description:

Anchor Size(mm)	Drill Dia(mm)	Plug Length(mm)	Screw Size(mm)
5x30	5	30	3.5x33
6x40	6	40	3.8x43
6x60	6	60	3.8x63
6x80	6	80	3.8x83
8x60	8	60	4.8x63
8x80	8	80	4.8x83
8x100	8	100	4.8x103
8x120	8	120	4.8x123

## Part NO:INT11462

Frame Fixing Anchor  
Material:PA6



### Description:

Anchor Size(mm)	Drill Dia(mm)	Plug Length(mm)	Screw Size(mm)
8x100	8	100	4.8x103
8x120	8	120	4.8x123
8x140	8	140	4.8x143
10x75	10	75	5.8x78
10x100	10	100	5.8x103
10x120	10	120	5.8x123
10x140	10	140	5.8x143
10x165	10	165	5.8x163

## Part NO:INT11460

Hammer Drive Anchor Countersunk Head, With Pozi Head Screw  
Material:(Sleeve)PA/PE; (Screw)Steel/Stainless Steel



### Description:

Anchor Size(mm)	Drill Dia(mm)	Plug Length(mm)	Screw Size(mm)
8x80	8	80	4.8x83
8x100	8	100	4.8x103
10x80	10	80	5.8x83
10x100	10	100	5.8x103

## Part NO:INT11464

Hammer Drive Anchor Mushroom Head, With Pozi Head Screw  
Material:PA6



### Description:

Anchor Size(mm)	Drill Dia(mm)	Plug Length(mm)	Screw Size(mm)
6x25	6	25	3.0x30
6x37	6	37	3.0x42
6x50	6	50	3.0x55

## Part NO:INT11461

Frame Fixing Anchor(Two Wings), With Pozi Head Self Drilling Screw  
Material:(Sleeve)PA; (Screw)Steel/Stainless Steel



### Description:

Anchor Size(mm)	Drill Dia(mm)	Plug Length(mm)	Screw Size(mm)
6x40	6	40	4.2x43
6x60	6	60	4.2x63
6x80	6	80	4.2x83
8x60	8	60	5.2x63
8x80	8	80	5.2x83
8x100	8	100	5.2x103
8x120	8	120	5.2x123
8x140	8	140	5.2x143
10x80	10	80	6.8x83
10x100	10	100	6.8x103
10x120	10	120	6.8x123
10x140	10	140	6.8x143
10x160	10	160	6.8x163

## Part NO:INT11465

Hammer Drive Anchor Round Head, With Pozi Head Screw  
Material:PA6



### Description:

Anchor Size(mm)	Drill Dia(mm)	Plug Length(mm)	Screw Size(mm)
6x25	6	25	3.0x30
6x37	6	37	3.0x42
6x50	6	50	3.0x55



## Wall Plugs

Welcome to our Wall Plug product collection — engineered for secure, stable, and long-lasting anchoring across various materials including concrete, brick, drywall, and stone. Our range includes standard expansion plugs, universal plugs, and more — designed to meet the needs of both professionals and DIY users. Whether you're mounting shelves, installing frames, or securing electrical fittings, our plugs ensure strong grip, easy installation, and durable performance.

## Part NO:INT11421

Wall Plug Without Lip  
Material:PA6/PE



### Description:

Anchor Size(mm)	Drill Dia(mm)	Plug Length(mm)	Screw Size(mm)
4x20	4	20	2.0-3.0
5x25	5	25	2.6-4.0
6x30	6	30	3.5-5.0
7x35	7	35	4.0-5.5
8x40	8	40	4.5-6.0
10x50	10	50	6.0-8.0
12x60	12	60	8.0-10.0
14x70	14	70	10.0-12.0
14x75	14	75	10.0-12.0
16x80	16	80	12.0-14.0

## Part NO:INT11466

Wall Plug With Lip  
Material:PA6/PE



### Description:

Anchor Size(mm)	Drill Dia(mm)	Plug Length(mm)	Screw Size(mm)
4x20	4	20	2.0-3.0
5x25	5	25	2.6-4.0
6x30	6	30	3.5-5.0
7x35	7	35	4.0-5.5
8x40	8	40	4.5-6.0
10x50	10	50	6.0-8.0
12x60	12	60	8.0-10.0
14x70	14	70	10.0-12.0
14x75	14	75	10.0-12.0
16x80	16	80	12.0-14.0

## Part NO:INT11467

Wall Plug Without Lip  
Material:PA6/PE



### Description:

Anchor Size(mm)	Drill Dia(mm)	Plug Length(mm)	Screw Size(mm)
5x25	5	25	2.6-4.0
6x30	6	30	3.5-5.0
7x35	7	35	4.0-5.5
8x40	8	40	4.5-6.0
10x50	10	50	6.0-8.0
12x60	12	60	8.0-10.0
14x70	14	70	10.0-12.0

## Part NO:INT11477

Four-side Expansion Anchor  
Material:PP



### Description:

Anchor Size(mm)
6x30
8x40
10x50
12x60

## Part NO:INT11472

Small Yellow Croaker Plastic Expansion Anchor  
Material:PE



### Description:

Anchor Size(mm)			
6x30	8x60	10x50	10x160
6x40	8x80	10x60	10x180
6x60	8x100	10x80	10x200
6x80	8x120	10x100	10x250
6x100	8x135	10x120	10x300
8x40	8x150	10x135	

## Part NO:INT11423

Universal Expansion Plug  
Material:PA6/PE



### Description:

Anchor Size(mm)

5x32
6x38
8x50
10x60

## Part NO:INT11475

Conical Lip Anchor  
Material:PE



### Description:

Anchor Size(mm)

5x19/Red
5x23/Red
7x27/Blue
8x35/Blue

## Part NO:INT11473

Super Expansion Anchor  
Material:PE



### Description:

Anchor Size(mm)

5x22/Yellow
6x25/White
7x32/Blue
8x40/Green

## Part NO:INT11422

Universal Expansion Plug  
Material:PP



### Description:

Anchor Size(mm)

6x35
8x50
10x60

## Part NO:INT11474

Ribbed Anchor  
Material:PE



### Description:

Anchor Size(mm)

5x22/Blue
6x25/Red
7x25/Red
8x30/Yellow
10x36/Green

## Part NO: INT11469

Wall Plug Without Lip  
Material:PA6/PE



### Description:

Anchor Size(mm)

8x40
------

## Part NO:INT11470

Wall Plug With Lip  
Material:PA6/PE



### Description:

Anchor Size(mm)

8x40
------

## Part NO:INT11479

Plastic Expension Pipe  
Material:PE



### Description:

Anchor Size(mm)

6x30
8x40

## Part NO:INT11485

Wall Plug  
Material:PE



### Description:

#### Anchor Size(mm)

5x25
6x25
6x38
7x38
7x50
8x38
8x50
10x38
10x50
10x65



## Speed Anchors

Introducing our Speed Anchor, a high-performance fastening solution engineered for quick installation, strong holding power, and versatile applications across construction and interior projects. Whether you're working with solid walls, hollow bricks, or drywall systems, the Speed Anchor delivers efficient anchoring without the need for complex tools or time-consuming setups. From professionals seeking productivity on site to distributors looking for quality and consistency, our Speed Anchor is the smart choice for your fastening needs.

Let performance lead the way — with Speed Anchor.

## Part NO:INT11442

Speed Anchor, Point.A  
Material:PA/POM



### Description:

Anchor Size(mm)

10x33

13x42

15x33

## Part NO:INT11485

Speed Anchor With “S” Type, Point.W  
Material:PA



### Description:

Anchor Size(mm)

16x38

## Part NO:INT11486

Speed Anchor, Point.A  
Material:PA



### Description:

Anchor Size(mm)

13x40

## Part NO:INT11441

Speed Anchor, Point.W  
Material:PA6



### Description:

Anchor Size(mm)

13x42

## Part NO:INT11443

Speed Anchor, Flat Type  
Material:PA6



### Description:

Anchor Size(mm)

14x22



## butterfly Toggle Anchors

Inspired by the elegant form of a butterfly, our Butterfly Toggle Anchors combine unique appearance with practical strength. The symmetrical winged design not only enhances visual appeal but also delivers outstanding performance in hollow wall installations.

Blending style and function, the Butterfly Toggle Anchor is more than just a fastener — it's a reliable solution with a refined design that sets your product offering apart.

## Part NO:INT11482

Butterfly Toggle(Light Type)  
Material:PA/PE



### Description:

Anchor Size(mm)

3-6

9-13

13-16

16-19

26-28

## Part NO:INT11424

Butterfly Toggle(Heavy Type)  
Material:PA/PE



### Description:

Anchor Size(mm)

10x29

10x36

10x45

## Part NO:INT11483

Butterfly Toggle  
Material:PA/PE



### Description:

Anchor Size(mm)

15x19



## PP Insulation Plugs

We are pleased to present our range of PP Insulation Plugs, designed to offer superior performance and reliable insulation solutions for a variety of applications. Explore this catalog to find the perfect insulation plug solutions tailored to your project requirements. For any inquiries or customized needs, please feel free to contact us — we are committed to supporting your success.

## Part NO:INT11436

PP Insulation Plug + Plastic Nail  
Material:PP



### Description:

Anchor Size(mm)

10x70
10x90
10x110
10x130

## Part NO:INT11444

PP Insulation Plug  
Material:PP



### Description:

Anchor Size(mm)

8x80
8x100
8x110
8x130

## Part NO:INT11484

PP Insulation Plug + Nail  
Material:PP



### Description:

Anchor Size(mm)

10x70
10x80
10x90
10x100
10x110
10x120
10x130
10x140
10x150
10x180
10x200
10x220



## Concrete Screws

Concrete screws offer a fast, reliable, and removable anchoring solution for use in solid base materials such as concrete, brick, and block. Designed with a specialized thread that cuts into the base material during installation, these screws provide high load capacity, reducing stress on the substrate. Ideal for structural and non-structural applications, concrete screws are easy to install, vibration-resistant, and available in multiple head styles and finishes to suit various construction and industrial needs. A smart choice for efficient and secure anchoring.

## Part NO:INT11509

Flange Head

Material:Carbon Steel / Stainless Steel

### Description:

Size(mm)	D	L	Loading Capacity C20/25
6x40	6	40	600kgs
6x50	6	50	800kgs
6x60	6	60	1000kgs
8x60	8	60	1500kgs
8x80	8	80	2000kgs
8x100	8	100	2500kgs
10x100	10	100	3000kgs
10x120	10	120	3500kgs



## Part NO:INT11510

Countersunk Head

Material:Carbon Steel / Stainless Steel

### Description:

Size(mm)	D	L	Loading Capacity C20/25
6x40	6	40	500kgs
6x60	6	60	700kgs
8x80	8	80	2000kgs
8x100	8	100	2000kgs



## Part NO:INT11511

Pan Head

Material:Carbon Steel / Stainless Steel

### Description:

Size(mm)	D	L	Loading Capacity C20/25
6x40	6	40	600kgs
6x60	6	60	600kgs



## Bolt Anchors

Bolt anchors are high-performance mechanical fasteners designed for secure anchoring in solid base materials such as concrete and natural stone. Ideal for heavy-duty applications, they provide reliable load-bearing capacity and long-term stability in structural and non-structural connections. Available in various designs—including wedge anchors, sleeve anchors, and torque-controlled types—bolt anchors offer excellent versatility for use in construction, industrial installations, and infrastructure projects. Quick to install and engineered for strength, they are a trusted solution for demanding anchoring requirements.

## Part NO:INT11512

Hexagonal Head  
Material:Carbon Steel &Nylon Ring



### Description:

Outside Diameter	Thread Diameter	Length/mm		Suitable thickness/mm	
		Min	Max	Min	Max
φ 10	M6	60	110	5	50
φ 12	M8	80	175	5	100
φ 16	M10	100	245	5	160
φ 18	M12	110	260	10	160
φ 24	M16	120	280	10	160
φ 28	M20	160	310	10	160

## Part NO:INT11513

Slotted Head  
Material:Carbon Steel &Nylon Ring



### Description:

Outside Diameter	Thread Diameter	Length/mm		Suitable thickness/mm	
		Min	Max	Min	Max
φ 32	M24	190	340	10	160

## Part NO:INT11514

Countersunk Head  
Material:Carbon Steel &Nylon Ring



### Description:

Outside Diameter	Thread Diameter	Length/mm		Suitable thickness/mm	
		Min	Max	Min	Max
φ 10	M6	70	90	10	30
φ 12	M8	85	105	10	30
φ 16	M10	95	115	10	30
φ 18	M12	110	130	10	30

## Part NO:INT11427

One Piece Shield Anchor  
Material:Carbon Steel  
Surface: Yellow Zinc,White Zinc



### Description:

Code	Size	D (mm)	L (mm)	Weight G/PC
INT11427/06	M6x45x0.7x1	6	45	8.1
INT11427/08	M8x50x0.9x12	8	50	14.5
INT11427/10	M10x55x1.2x1	10	55	24.4
INT11427/12	M12x75x1.3x18	12	75	44.2

## Part NO:INT11431

Wedge Anchor  
Material:Carbon Steel, Stainless Steel  
Surface:Zinc Plated,Clean, HDG



### Description:

Code	Size	D (mm)	L (mm)	Unit Weight G/PC
INT11431/M08100	M8 - 1.25x100	8	100	36.86
INT11431/M10065	M10 - 1.5x65	10	65	46.66
INT11431/M10080	M10 - 1.5x80	10	80	54.01
INT11431/M10090	M10 - 1.5x90	10	90	57.88
INT11431/M10100	M10 - 1.5x100	10	100	62.88
INT11431/M10120	M10 - 1.5x120	10	120	73.29
INT11431/M12070	M12 - 1.75x70	12	70	71.3
INT11431/M12100	M12 - 1.75x100	12	100	92.3
INT11431/M12120	M12 - 1.75x120	12	120	105.8
INT11431/M12130	M12 - 1.75x130	12	130	111.8
INT11431/M12150	M12 - 1.75x150	12	150	125.9
INT11431/M16090	M16 - 2.0x90	16	90	156.02
INT11431/M16120	M16 - 2.0x120	16	120	195.72
INT11431/M16150	M16 - 2.0x150	16	150	235.52
INT11431/M16200	M16 - 2.0x200	16	200	302.5

## Part NO:INT11428

Two Piece Shield Anchor  
Material:Carbon Steel  
Surface: Yellow Zinc.White Zinc



### Description:

Code	Size	D (mm)	L (mm)	Weight G/PC
INT11428/06	M6x40x1.4x12	6	40	16.7
INT11428/08	M8x45x1.4x16	8	45	22.4
INT11428/10	M10x60x1.4x16	10	60	34.5
INT11428/12	M12x70x1.8x20	12	70	67.2

## Part NO:INT11429

Three Piece Shield Anchor  
Material:Carbon Steel  
Surface: Yellow Zinc.White Zinc



### Description:

Code	Size	D (mm)	L (mm)	Weight G/PC
INT11429/06	M6x45x1.5x12	6	45	17.2
INT11429/08	M8x50x1.8x14	8	50	26.5
INT11429/10	M10x60x2.0x17	10	60	36.5
INT11429/12	M12x75x2.3x20	12	75	67.4

## Part NO:INT11430

Four Piece Shield Anchor  
Material:Carbon Steel  
Surface: Yellow Zinc.White Zinc



### Description:

Code	Size	D (mm)	L (mm)	Weight G/PC
INT11430/06	M6x40x1.2x10	6	40	10.3
INT11430/08	M8x50x1.5x14	8	50	20
INT11430/10	M10x60x1.8x16	10	60	32
INT11430/12	M12x80x1.8x20	12	80	67.5

## Part NO:INT11435

Wire Anchor  
Material: Carbon Steel  
Surface: Yellow Zinc, White Zinc



### Description:

Code	Size	D (mm)	L (mm)	Unit Weight G/PC
INT11435	M6x50	6	50	9.53
INT11435	M6x55	6	55	10.63
INT11435	M6x60	6	55	11.7

## Part NO:INT11437

Tank Anchor  
Material: Carbon Steel  
Surface: Yellow Zinc, White Zinc



### Description:

Code	Size	D (mm)	L (mm)	weight G/PC not conclude nail
INT11437	M5x30	5	30	1.7
INT11437	M6x32	6	32	2.25
INT11437	M8x38	8	38	5.86
INT11437	M8x60	8	60	9.43
INT11437	M10x60	10	60	11.71

## Part NO:INT11433

Express Nails  
Material:Manganese Steel  
Surface:Zinc Plated



### Description:

Code	Size	A (mm)	D (mm)	Thickness (mm)	Unit Weight G/PC
INT11433/6060	6x60	6	60	0.8	5.5
INT11433/6080	6x80	6	80	0.8	7.65
INT11433/6100	6x100	6	100	0.8	9.8
INT11433/8070	8x70	8	70	1	10.9
INT11433/8090	8x90	8	90	1	14.2
INT11433/8110	8x110	8	110	1	17.3
INT11433/8130	8x130	8	130	1	20.8
INT11433/8150	8x150	8	150	1	23.5

## Part NO:INT11409

Metal Frame Anchor  
Material:Carbon Steel  
Surface: Yellow Zinc,White Zinc



### Description:

Size	D (mm)	L (mm)	Unit Weight G/PC
M5x8x72	8	72	20.3
M5x8x92	8	92	28
M5x8x112	8	112	29.6
M5x8x132	8	132	34.1
M5x8x152	8	152	41.2
M5x8x172	8	172	49.9
M6x10x72	10	72	29.4
M6x10x92	10	92	36.4
M6x10x112	10	112	40.6
M6x10x132	10	132	47.6
M6x10x152	10	152	54.4
M6x10x182	10	182	61
M6x10x202	10	202	70.5

## Part NO:INT11519

Hollow Frame Anchor  
Material:Carbon Steel  
Surface: Yellow Zinc,White Zinc



### Description:

Size	D (mm)	L (mm)	Unit Weight G/PC
M6x10x112	10	112	45.6
M6x10x132	10	132	52.6
M6x10x152	10	152	59.4
M6x10x182	10	182	66.0

## Part NO:INT11409

Drop In Anchor(Type A)  
Material: Carbon Steel  
Body Type:Knurled, Round  
Surface:Zinc Plated



### Description:

Size	D (mm)	L (mm)	Unit Weight G/PC
M6x8x25	8	25	6.3
M8x10x30	10	30	11.5
M10x12x40	12	40	21
M12x16x50	16	50	54
M16x20x65	20	65	103
M20x25x80	25	80	206
5/8 - 11x20x65	20	65	130
3/8 - 16x12x40	12	40	22
5/16 - 18x10x30	10	30	11.5

## Part NO:INT11434

Metal Ceiling Anchor  
 Material:Carbon Steel  
 Surface:Plain, Yellow Zinc, White Zinc



### Description:

Size	D (mm)	L (mm)	Unit Weight G/PC
6x35	6	35	10.9
6x40	6	40	12.45
6x65	6	65	17.8

## Part NO:INT11410

Zinc Alloy Nails In Anchor  
 Material:Zinc Alloy  
 Surface:Self Color/ Zinc Plated



### Description:

Code	Size	D (mm)	L (mm)	Unit Weight G/PC
INT11410/640	6x40	6	40	9.8
INT11410/650	6x50	6	50	12
INT11410/665	6x65	6	65	14.6



## snap Toggle Anchors

The Snap Toggle Anchor is a high-performance heavy-duty toggle bolt designed for hollow walls, including drywall, plaster, and hollow concrete block. With its unique pivoting mechanism and solid metal channel, the Snap Toggle Anchor offers exceptional holding power, fast installation, and reliable performance — even under demanding load conditions.

Whether you're a contractor, builder, or DIY enthusiast, our Snap Toggle Anchors are the go-to choice for mounting shelves, cabinets, TVs, and other heavy fixtures. Engineered for strength. Built for confidence.

## Part NO:INT11425

PA Snap Toggle Anchor

Material: PA & Carbon Steel



### Description:

Anchor Size(mm)

3/16"

1/4"



### Description:

Anchor Size(mm)

3/16"

1/4"

5/16"

3/8"

1/2"



## Cavity Anchors

Cavity anchors are specially designed for use in hollow wall structures, providing secure and reliable fixing solutions for masonry veneers, cavity walls, and lightweight construction materials. Engineered to distribute loads effectively and enhance structural integrity, they offer superior performance in both vertical and lateral applications. With a wide range of types to suit different wall thicknesses and installation conditions, cavity anchors are essential components in modern façade and cladding systems, combining ease of installation with long-term durability.

## Part NO:INT11414

Hollow Wall Anchor With Machine Screw  
 Material:Carbon Steel  
 Surface:Plain, Yellow Zinc, White Zinc



### Description:

Size	D (mm)	L (mm)	Unit Weight G/PC
M4 - 0.7x20	4	20	4.8
M4 - 0.7x32	4	32	6.5
M4 - 0.7x38	4	38	7.4
M4 - 0.7x46	4	46	8.4
M4 - 0.7x60	4	60	10.5
M5 - 0.8x37	5	37	12.2
M5 - 0.8x52	5	52	15.5
M5 - 0.8x65	5	65	18.8
M5 - 0.8x80	5	80	22.4
M6 - 1.0x37	6	37	15.4
M6 - 1.0x52	6	52	21
M6 - 1.0x65	6	65	26.4
M6 - 1.0x80	6	80	30.6

## Part NO:INT11416

Hollow Wall Anchor With C Hook Screw  
 Material:Carbon Steel  
 Surface:Plain, Yellow Zinc, White Zinc



### Description:

Size	D (mm)	L (mm)	Unit Weight G/PC
M4 - 0.7x32	4	32	9
M4 - 0.7x38	4	38	10.1
M4 - 0.7x60	4	60	12
M5 - 0.8x52	5	52	20.5

## Part NO:INT11415

Hollow Wall Anchor With L Hook Screw  
 Material:Carbon Steel  
 Surface:Plain, Yellow Zinc, White Zinc



### Description:

Size	D (mm)	L (mm)	Unit Weight G/PC
M4-0.7x32	4	32	8.2
M4-0.7x38	4	38	9.4
M5-0.8x52	5	52	18
M6-1.0x52	6	52	27
M6-1.0x65	6	65	32

## Part NO:INT11417

Hollow Wall Anchor With O Hook Screw  
 Material:Carbon Steel  
 Surface:Plain, Yellow Zinc, White Zinc



### Description:

Size	D (mm)	L (mm)	Unit Weight G/PC
M4 - 0.7x32	4	32	9.5
M4 - 0.7x38	4	38	10.5
M5 - 0.8x52	5	52	22

## Part NO:INT11449

Spring Toggle With Machine Screw  
 Material:Carbon steel  
 Surface:Yellow Zinc, White Zinc



### Description:

Size	Unit Weight G/PC
M5x50	12.4
M5x75	13.8
M6x50	21.5
M6x75	23.5

## Part NO:INT11440

Spring Toggle With C Hook Screw  
 Material:Carbon steel  
 Surface:Yellow Zinc,White Zinc

### Description:

Size	Unit Weight G/PC
M4x80	16.1
M5x80	28.4
M6x80	31

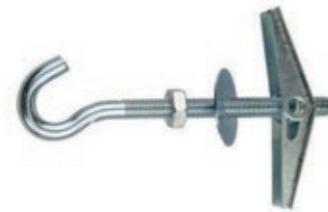

## Part NO:INT11439

Spring Toggle With O Hook Screw  
 Material:Carbon Steel  
 Surface: Yellow Zinc,White Zinc

### Description:

Size	Unit Weight G/PC
M4x80	14.1
M5x80	22
M6x80	29



## Part NO:INT11418-420, 515-518

Zamak Selfdrilling Anchor  
 Material:Zinc Alloy



### Description:

Code	Size	D (mm)	L (mm)	Unit Weight G/PC
INT11515	15x25	15	25	4.3
INT11516	14x28	14	28	3.7
INT11517	14x31	14	31	4.0
INT11518	14x42	14	42	6.4
INT11418	13x32	13	32	3.6
INT11419	15x32	15	32	6.1
INT11420	14x38	14	38	5.2